

LANSEN

QUICK INSTALLATION GUIDE

INDOOR/OUTDOOR LONG RANGE MAINS REPEATER

[LAN-WMBUS-R4-M-LR-A2]



IMPORTANT!

Appropriate disconnection device, such as a power supply cable with socket, shall be used as part of the building instruction. It should be close to the device and easily accessible to the user. Furthermore, a 230 VAC installation MUST be carried out by authorized installer according to the relevant electrical safety regulations.

Recommended mounting instructions:

- Keep at least 30cm in all directions to other objects or walls/ceiling/floor.
- Can be mounted on many things such as walls, poles, and masts.
- The label on the device MUST be on the left side and the power cable outlet MUST be pointing downwards, for the device to be fully protected against water.

Installation location and direction:

It is recommended to install the repeater upright on a wall, pole, pipe, or similar, but it can be installed on a ceiling as well. It is highly recommended to mount the device as the image below.

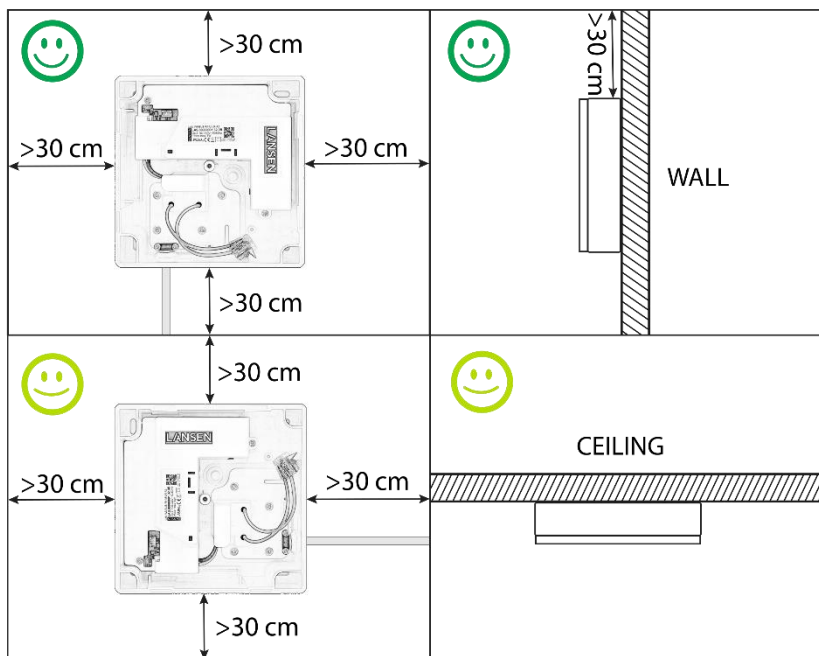

Step 1

Find a suitable place to install the repeater. If indoors, then walls are recommended. If outdoors, then walls, poles, or similar works great. To mount a repeater on poles, it's recommended to use the Lansen pole mounting kit (article number LAN-910-0066).

Step 2

Unscrew the screw (marked with a red circle on the image below) and remove the cover by pushing the clips at both sides of the cover.

Note: The screw is a Security Torx T20H (with a small pin in the middle).

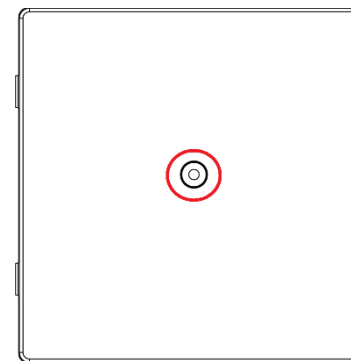

Step 3

Note: Do not use the hole on the back for outdoor usage!

The power supply cable can be mounted either through the cable guide at the bottom or through the hole on the back. By using the hole on the back, the repeater can be mounted directly on an outlet to hide cables.

- If the hole at the back is going to be used, go to **Step 4**.
- If the cable guide on the side is going to be used, go to **Step 5**.

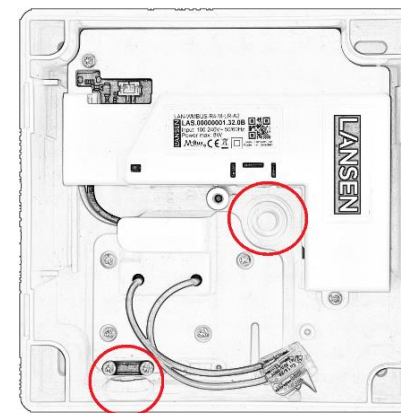

Step 4

Note: This solution gives IP-class IP40. Do NOT use this for outdoor installations!

To use the hole at the back for power supply cable, carefully cut, drill, or punch out the hole marked in the picture above.

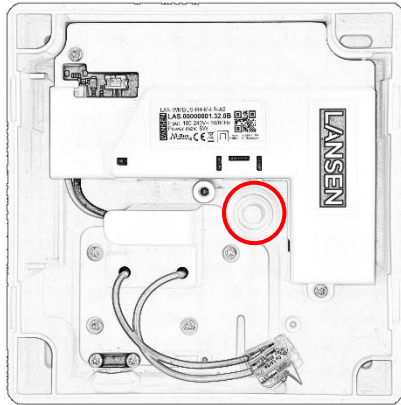

Step 5

Strip the power supply cable according to the diagram below.

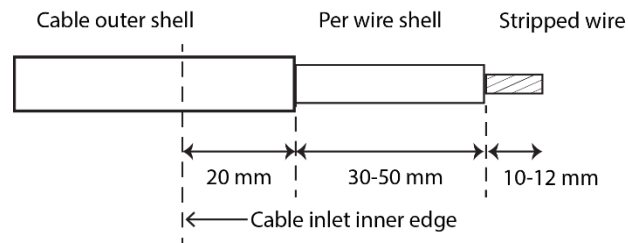

Step 6

Depending on how the repeater is going to be installed, one must follow different mounting instructions:

- Mounting on a wall: Go to **Step 7**
- Mounting on pole or mast: Go to **Step 8**

Step 7 (Installation on wall)

Take the repeater and hold it where it is going to be mounted. Mark the holes (red circles), pre-drill if necessary (depending on the material), and mount the device by using four screws (not included). Continue to **Step** Error! Reference source not found..

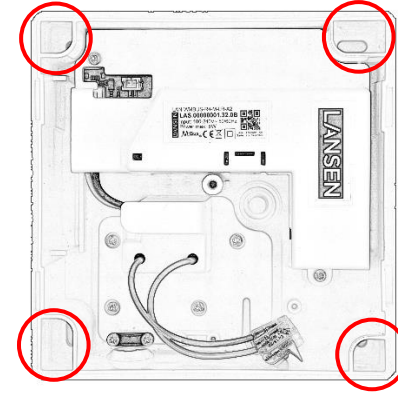

Step 8 (Installation on pole/pipe/mast)

Install the Lansen pole mounting kit (article number LAN-910-0066) on the back of the repeater. Pull the straps through the holes and wrap it around the pole or pipe which the repeater is going to be mounted on and tighten the straps, so it is securely mounted.

Note: More detailed instructions with pictures will be available in next version of the Installation guide!

Step 9

Thread the power supply cable (prepared in Error! Reference source not found.) through the cable inlet, either from the back of the repeater or on the side (marked by red circles). Connect the power supply cable to the coupling clamps on the inside (marked by blue circle).

Note: If using the cable guide on the side, make sure to use the strain relief (marked by green circle) which is included in the package.

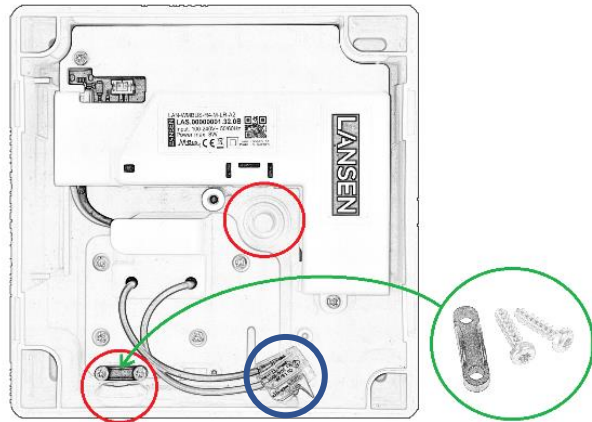

Step 10

Connect power to the repeater. Three beeps will be heard during startup and a red LED will start blinking once for every packet the repeater retransmits.

Note: If more beeps are heard a few seconds (~5s) after the first beeps, this indicates a problem with the device. Please contact place of purchase.

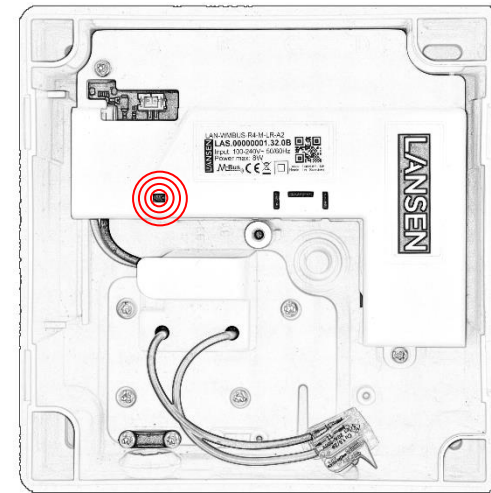

Step 11

Attach the cover and mount the screw (marked with a red circle on the image below). Make sure the clips at both sides of the cover are firmly attached.

Note: The screw is a Security Torx T20H (with a small pin in the middle).

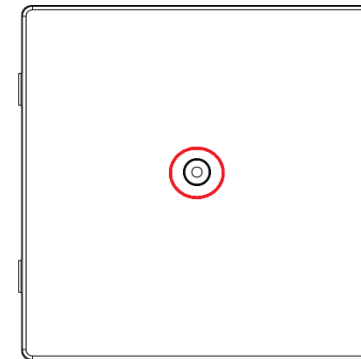

Installation is now complete!

